

# Data Sheet for Precision Resistor

Power Resistor in Ceramic Housing (wirewound)

Series MCV

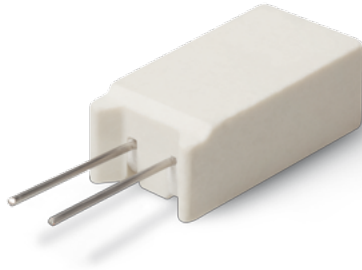

- Wirewound resistor, inorganic construction
- Power rating up to 10 Watt
- Resistance values from 0.01Ω..90kΩ
- Resistance tolerances up to ±0.01%
- TCR ±20ppm/°C R>10Ω
- Non-inductive windings (option)
- Flame proofed

Electrical Specification	MCV				
	1	2	3	4	5
Resistance range	0.01Ω..12kΩ	0.01Ω..22kΩ	0.01Ω..45kΩ	0.01Ω..65kΩ	0.01Ω..91kΩ
Resistance tolerance	±0.01%..±10%				
Power rating @ 70°C (0W bei +275°C)	2W	3W	5W	7W	10W
TCR-rate	±20ppm/°C @ R > 10Ω, ±50ppm/°C @ R ≥ 1Ω..10Ω (±90ppm/°C @ R < 1Ω on request)				
Working temperature range (max.)	-55 °C up to +275 °C				

Mechanical Specification	
Resistance technology / material	Wirewound / wire alloy
Housing material	Ceramics
Connections	Radial cooper tinned

Parameters	Test Conditions (MIL-STD 202)	Specification
Dielectric	See norm	±0.2% +0.05Ω
Load life	See norm	±1% +0.05Ω
Storage	See norm	±0.2% +0.05Ω
Moisture resistance	See norm	±0.2% +0.05Ω
Thermal shock	See norm	±0.2% +0.05Ω
5X Overload ( 5s )	See norm	±0.2% +0.05Ω
Shock	See norm	±0.1% + 0.05Ω
Vibration	See norm	±0.1% + 0.05Ω
Dielectric strength: 1500 VAC		

# Data Sheet for Precision Resistor

Power Resistor in Ceramic Housing (wirewound)

Series MCV

## Power Derating Curve

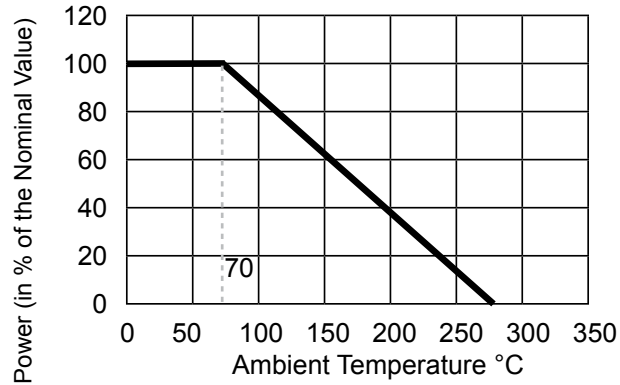

## Technical Drawing

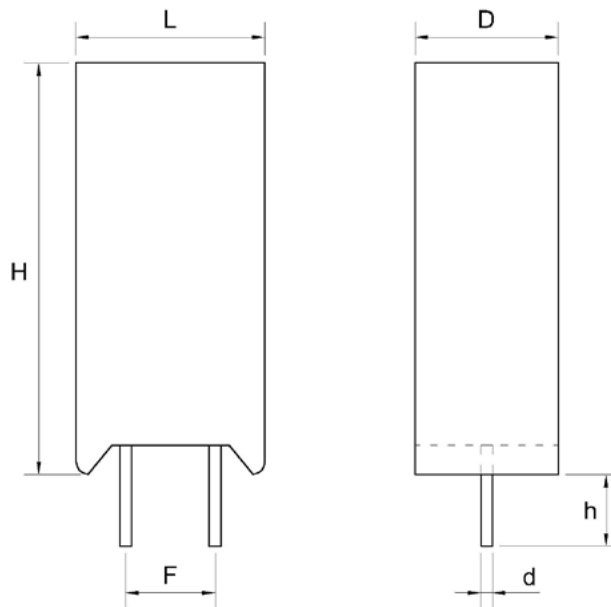

## Dimensions in mm

	<b>H</b> ±1.5	<b>L</b> ±1.0	<b>D</b> ±1.0	<b>F</b> ±0.4	<b>Ø d</b> ±0.05	<b>h</b>
MCV-1	20.3	11.0	7.0	5.1	0.8	2.5min. /6.1max.
MCV-2	25.4	12.1	8.1	5.1	0.8	2.5min. /6.1max.
MCV-3	25.4	13.2	8.9	5.1	0.8	2.5min. /6.1max.
MCV-4	38.7	13.2	9.7	5.1	1.0	2.5min. /6.1max.
MCV-5	35.1	16.1	12.2	7.6	1.0	2.5min. /6.1max.

# Data Sheet for Precision Resistor

Power Resistor in Ceramic Housing (wirewound)

Series MCV

Order code						
<b>Description</b>	Selection: <b>standard=black/bold</b> , possible <i>options=grey/italic</i>					
<b>Series:</b>	<b>MCV</b>					
<b>Type / size:</b>						
1 (max. 12kΩ)		1				
2 (max. 22kΩ)		2				
3 (max. 45kΩ)		3				
4 (max. 65kΩ)		4				
5 (max. 91kΩ)		5				
<b>Resistance tolerance:</b>						
±0,02%				<b>W0,02%</b>		
±0,05%				<b>W0,05%</b>		
±0,1%				<b>W0,1%</b>		
±0,25%				<b>W0,25%</b>		
±0,5%				<b>W0,5%</b>		
±1%				<b>W1%</b>		
±5%				<b>W5%</b>		
±10%				<b>W10%</b>		
<i>Option ±0,01%</i>				<i>W0,01%</i>		
<b>Temperature coefficient:</b>						
±20ppm/°C @ R >10Ω					<b>TK20</b>	
±50ppm/°C @ R ≥ 1Ω..10Ω					<b>TK50</b>	
<i>Option ±90ppm/°C @ R &lt; 1Ω</i>					<i>TK90</i>	
<b>Resistance value - please choose:</b>						
<b>From 0,01Ω bis ≤ see type</b>						<b>xxkxxx</b>
<i>Option non-inductive windings: max. resistance value / 2</i>						<i>N</i>

Order Example	Series	Type	Resistance tolerance	Temperature coefficient	Resistance value	Inductance
Choice	MCV	1	±1%	20ppm/°C	10,1kΩ	Standard
Code	MCV	1	W1%	TK20	10k100	-